

MINIATURE SMD CHIP CHOKE COILS

闭磁路贴片电感

Shielded SMD Power Inductors

Operating Temp:-30℃ ~ 100℃



特征:

- 小尺寸与电极连接到铁芯直接。
- 利于磁屏蔽。
- 低直流电阻。
- 适合大电流。
- 可利用的磁带和自动卷轴表面的设置。

FEATURES:

- Small size with the electrode attached to the ferrite core directly.
- Available in magnetically shielded.
- Low DC resistance.
- Suitable for large currents.
- Available on tape and reel for auto surface mounting.

用途:

- 录像机。
- OA 仪器。
- 液晶电视。
- 笔记本计算机。
- 小型通信机器。
- DC/DC 变压器 DSC, DVC, MP3, PDA 等产。

APPLICATIONS:

- Power supply for VTRs.
- OA equipment
- LCD televisions.
- Notebook PCs.
- Portable communication equipment.
- DC/DC converters, DSC, DVC, MP3, PDA, products.

产品型号:

PRODUCT IDENTIFICATION:

SMRH	5D28	220	N	T													
①	②	③	④	⑤													
①	③		④		⑤												
<table border="1"> <tr><td colspan="2">类型 Type</td></tr> <tr><td>SMRH</td><td>闭磁路贴片电感 Shielded SMT Power Inductors</td></tr> </table>	类型 Type		SMRH	闭磁路贴片电感 Shielded SMT Power Inductors	<table border="1"> <tr><td colspan="2">外形尺寸(LxH) (mm) External Dimensions (LxWxH) (mm)</td></tr> <tr><td>5D28</td><td>5.7x5.7x3.0</td></tr> </table>		外形尺寸(LxH) (mm) External Dimensions (LxWxH) (mm)		5D28	5.7x5.7x3.0	<table border="1"> <tr><td colspan="2">Inductance</td></tr> <tr><td colspan="2">22 uH</td></tr> </table>			Inductance		22 uH	
类型 Type																	
SMRH	闭磁路贴片电感 Shielded SMT Power Inductors																
外形尺寸(LxH) (mm) External Dimensions (LxWxH) (mm)																	
5D28	5.7x5.7x3.0																
Inductance																	
22 uH																	
④	⑤																
<table border="1"> <tr><td colspan="2">Tolerance</td></tr> <tr><td colspan="2">J: ±5%, K: ±10%, L: ±15%</td></tr> <tr><td colspan="2">M: ±20%, P: ±25%, N: ±30%</td></tr> </table>	Tolerance		J: ±5%, K: ±10%, L: ±15%		M: ±20%, P: ±25%, N: ±30%		<table border="1"> <tr><td colspan="2">包装 Packing</td></tr> <tr><td>B</td><td>散装 Bulk Package</td></tr> <tr><td>T</td><td>编带 Tape & Reel</td></tr> </table>		包装 Packing		B	散装 Bulk Package	T	编带 Tape & Reel			
Tolerance																	
J: ±5%, K: ±10%, L: ±15%																	
M: ±20%, P: ±25%, N: ±30%																	
包装 Packing																	
B	散装 Bulk Package																
T	编带 Tape & Reel																

Shape and Size(Dimension are in mm):

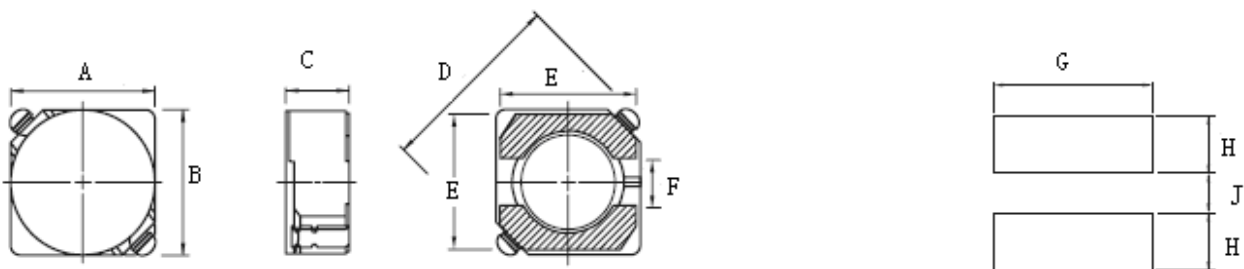

Part No	A (max)	B(max)	C(max)	D(max)	E(max)	F	G	H	J
---------	---------	--------	--------	--------	--------	---	---	---	---

MINIATURE SMD CHIP CHOKE COILS

SMRH2D09	3.2	3.2	1.1	4.2	3.3	2.1	1.3	1.3	1.7
SMRH2D11	3.2	3.2	1.3	4.2	3.3	2.1	1.3	1.3	1.7
SMRH2D14	3.2	3.2	1.6	4.2	3.3	2.1	1.3	1.3	1.7
SMRH2D18	3.2	3.2	2.0	4.2	3.3	2.1	1.3	1.3	1.7
SMRH3D11	4.0	4.0	1.4	5.5	3.7	1.2	4.5	1.5	1.2
SMRH3D14	4.0	4.0	1.7	5.5	3.7	1.2	4.5	1.5	1.2
SMRH3D16	4.0	4.0	2.0	5.5	3.7	1.2	4.5	1.5	1.2
SMRH3D28	4.0	4.0	3.1	5.5	3.7	1.2	4.5	1.5	1.2
SMRH4D18	5.0	5.0	2.0	6.9	4.5	1.5	5.3	1.9	1.5
SMRH4D28	5.0	5.0	3.0	6.9	4.5	1.5	5.3	1.9	1.5
SMRH5D18	6.0	6.0	2.0	8.2	5.5	2.0	6.3	2.15	2.0
SMRH5D28	6.0	6.0	3.0	8.2	5.5	2.0	6.3	2.15	2.0
SMRH6D28	7.0	7.0	3.0	9.5	6.5	2.0	7.3	2.65	2.0
SMRH6D38	7.0	7.0	4.0	9.5	6.5	2.0	7.3	2.65	2.0

SMRH2D09 Series

Part No.	Inductance (uH)			Quality Factor		DCR (OHM) Max	Rated DC Current (Amp)Max
	Nominal Value	Tole.	Test Freq.	Spec. Min	Test Freq.		
SMRH2D09-1R2N	1.2	N	100KHz	20	1MHz	0.097	0.80
SMRH2D09-1R5N	1.5	N	100KHz	20	1MHz	0.110	0.73
SMRH2D09-1R8N	1.8	N	100KHz	20	1MHz	0.131	0.65
SMRH2D09-2R2N	2.2	N	100KHz	20	1MHz	0.143	0.60
SMRH2D09-2R7N	2.7	N	100KHz	20	1MHz	0.150	0.53
SMRH2D09-3R3N	3.3	N	100KHz	20	1MHz	0.193	0.47
SMRH2D09-3R9N	3.9	N	100KHz	20	1MHz	0.225	0.45
SMRH2D09-4R7N	4.7	N	100KHz	30	1MHz	0.287	0.41
SMRH2D09-5R6N	5.6	N	100KHz	30	1MHz	0.325	0.37
SMRH2D09-6R8N	6.8	N	100KHz	30	1MHz	0.425	0.33
SMRH2D09-8R2N	8.2	N	100KHz	30	1MHz	0.475	0.30
SMRH2D09-100N	10	M	100KHz	35	1MHz	0.537	0.28
SMRH2D09-120 M	12	M	100KHz	35	1MHz		
SMRH2D09-150 M	15	M	100KHz	35	1MHz		
SMRH2D09-220 M	22	M	100KHz	35	1MHz		
SMRH2D09-330 M	33	M	100KHz	35	1MHz		
SMRH2D09-470 M	47	M	100KHz	35	1MHz		

SMRH2D11 Series

MINIATURE SMD CHIP CHOKE COILS

Part No.	Inductance (uH)			Quality Factor		DCR (OHM) Max	Rated DC Current (Amp)Max
	Nominal Value	Tole.	Test Freq.	Spec. Min	Test Freq.		
SMRH2D11-1R2N	1.2	N	100KHz	20	1MHz		
SMRH2D11-1R5N	1.5	N	100KHz	20	1MHz	0.068	0.90
SMRH2D11-1R8N	1.8	N	100KHz	20	1MHz		
SMRH2D11-2R2N	2.2	N	100KHz	20	1MHz	0.098	0.78
SMRH2D11-2R7N	2.7	N	100KHz	20	1MHz		
SMRH2D11-3R3N	3.3	N	100KHz	20	1MHz	0.132	0.60
SMRH2D11-3R9N	3.9	N	100KHz	20	1MHz		
SMRH2D11-4R7N	4.7	N	100KHz	30	1MHz	0.240	0.50
SMRH2D11-5R6N	5.6	N	100KHz	30	1MHz		
SMRH2D11-6R8N	6.8	N	100KHz	30	1MHz	0.360	0.44
SMRH2D11-8R2N	8.2	N	100KHz	30	1MHz		
SMRH2D11-100N	10	N	100KHz	35	1MHz	0.400	0.35
SMRH2D11-120 M	12	M	100KHz	35	1MHz		
SMRH2D11-150 M	15	M	100KHz	35	1MHz		
SMRH2D11-220 M	22	M	100KHz	35	1MHz		
SMRH2D11-330 M	33	M	100KHz	35	1MHz		
SMRH2D11-470 M	47	M	100KHz	35	1MHz		

SMRH2D14 Series

Part No.	Inductance (uH)			Quality Factor		DCR (OHM) Max	Rated DC Current (Amp)Max
	Nominal Value	Tole.	Test Freq.	Spec. Min	Test Freq.		
SMRH2D14-1R2N	1.2	N	100KHz	20	1MHz		
SMRH2D14-1R5N	1.5	N	100KHz	20	1MHz	0.063	1.80
SMRH2D14-1R8N	1.8	N	100KHz	20	1MHz	0.075	1.65
SMRH2D14-2R2N	2.2	N	100KHz	20	1MHz	0.094	1.50
SMRH2D14-2R7N	2.7	N	100KHz	20	1MHz	0.106	1.35
SMRH2D14-3R3N	3.3	N	100KHz	20	1MHz	0.125	1.20
SMRH2D14-3R9N	3.9	N	100KHz	20	1MHz	0.138	1.10
SMRH2D14-4R7N	4.7	N	100KHz	30	1MHz	0.185	1.00
SMRH2D14-5R6N	5.6	N	100KHz	30	1MHz	0.220	0.95
SMRH2D14-6R8N	6.8	N	100KHz	30	1MHz	0.250	0.85
SMRH2D14-8R2N	8.2	N	100KHz	30	1MHz	0.281	0.80
SMRH2D14-100N	10	N	100KHz	35	1MHz	0.318	0.65
SMRH2D14-120 M	12	M	100KHz	35	1MHz	0.438	0.62
SMRH2D14-150 M	15	M	100KHz	35	1MHz		
SMRH2D14-220 M	22	M	100KHz	35	1MHz		
SMRH2D14-330 M	33	M	100KHz	35	1MHz		
SMRH2D14-470 M	47	M	100KHz	35	1MHz		

SMRH2D18Series

MINIATURE SMD CHIP CHOKE COILS

Part No.	Inductance (uH)			Quality Factor		DCR (OHM) Max	Rated DC Current (Amp)Max
	Nominal Value	Tole.	Test Freq.	Spec. Min	Test Freq.		
SMRH2D18-1R2N	1.2	N	100KHz	20	1MHz		
SMRH2D18-1R5N	1.5	N	100KHz	20	1MHz		
SMRH2D18-1R8N	1.8	N	100KHz	20	1MHz		
SMRH2D18-2R2N	2.2	N	100KHz	20	1MHz	0.041	0.85
SMRH2D18-2R7N	2.7	N	100KHz	20	1MHz		
SMRH2D18-3R3N	3.3	N	100KHz	20	1MHz	0.054	0.75
SMRH2D18-3R9N	3.9	N	100KHz	20	1MHz		
SMRH2D18-4R7N	4.7	N	100KHz	30	1MHz	0.078	0.63
SMRH2D18-5R6N	5.6	N	100KHz	30	1MHz		
SMRH2D18-6R8N	6.8	N	100KHz	30	1MHz	0.115	0.52
SMRH2D18-8R2N	8.2	N	100KHz	30	1MHz		
SMRH2D18-100N	10	N	100KHz	35	1MHz	0.180	0.43
SMRH2D18-120 M	12	M	100KHz	35	1MHz		
SMRH2D18-150 M	15	M	100KHz	35	1MHz	0.220	0.35
SMRH2D18-220 M	22	M	100KHz	35	1MHz	0.363	0.30
SMRH2D18-330 M	33	M	100KHz	35	1MHz	0.516	0.24
SMRH2D18-470 M	47	M	100KHz	35	1MHz	0.750	0.20

SMRH3D11 Series

Part No.	Inductance (uH)			Quality Factor		DCR (OHM) Max	Rated DC Current (Amp)Max
	Nominal Value	Tole.	Test Freq.	Spec. Min	Test Freq.		
SMRH3D11-1R5N	1.5	N	100KHz	20	1MHz		
SMRH3D11-2R2N	2.2	N	100KHz	20	1MHz		
SMRH3D11-2R4N	2.4	N	100KHz	20	1MHz		
SMRH3D11-2R7N	2.7	N	100KHz	20	1MHz	0.105	0.53
SMRH3D11-3R2N	3.2	N	100KHz	20	1MHz		
SMRH3D11-3R3N	3.3	N	100KHz	20	1MHz		
SMRH3D11-4R7N	4.7	N	100KHz	30	1MHz	0.156	0.4
SMRH3D11-6R8N	6.8	N	100KHz	30	1MHz	0.225	0.34
SMRH3D11-8R2N	8.2	N	100KHz	30	1MHz	0.294	0.32
SMRH3D11-100N	10	N	100KHz	30	1MHz	0.338	0.28
SMRH3D11-120 M	12	M	100KHz	35	1MHz	0.418	0.25
SMRH3D11-150 M	15	M	100KHz	35	1MHz	0.550	0.23
SMRH3D11-180 M	18	M	100KHz	35	1MHz	0.626	0.21
SMRH3D11-220 M	22	M	100KHz	35	1MHz	0.731	0.19
SMRH3D11-330 M	33	M	100KHz	35	1MHz	1.108	0.17
SMRH3D11-390 M	39	M	100KHz	35	1MHz	1.390	0.15
SMRH3D11-470 M	47	M	100KHz	35	1MHz		0.14

SMRH3D14 Series

MINIATURE SMD CHIP CHOKE COILS

Part No.	Inductance (uH)			Quality Factor		DCR (OHM) Max	Rated DC Current (Amp)Max
	Nominal Value	Tole.	Test Freq.	Spec. Min	Test Freq.		
SMRH3D14-1R5N	1.5	N	100KHz	20	1MHz	0.076	2.6
SMRH3D14-2R2N	2.2	N	100KHz	20	1MHz		
SMRH3D14-2R4N	2.4	N	100KHz	20	1MHz	0.129	2.0
SMRH3D14-2R7N	2.7	N	100KHz	20	1MHz		
SMRH3D14-3R2N	3.2	N	100KHz	20	1MHz	0.139	1.8
SMRH3D14-3R3N	3.3	N	100KHz	20	1MHz		
SMRH3D14-4R7N	4.7	N	100KHz	30	1MHz	0.214	1.45
SMRH3D14-6R8N	6.8	N	100KHz	30	1MHz	0.290	1.20
SMRH3D14-8R2N	8.2	N	100KHz	30	1MHz		
SMRH3D14-100N	10	N	100KHz	30	1MHz	0.44	1.00
SMRH3D14-120 M	12	M	100KHz	35	1MHz		
SMRH3D14-150 M	15	M	100KHz	35	1MHz	0.65	0.80
SMRH3D14-180 M	18	M	100KHz	35	1MHz		
SMRH3D14-220 M	22	M	100KHz	35	1MHz	0.83	0.65
SMRH3D14-330 M	33	M	100KHz	35	1MHz		
SMRH3D14-390 M	39	M	100KHz	35	1MHz		
SMRH3D14-470 M	47	M	100KHz	35	1MHz		

SMRH3D16 Series

Part No.	Inductance (uH)			Quality Factor		DCR (OHM) Max	Rated DC Current (Amp)Max
	Nominal Value	Tole.	Test Freq.	Spec. Min	Test Freq.		
SMRH3D16-1R5N	1.5	N	100KHz	20	1MHz	0.052	1.55
SMRH3D16-2R2N	2.2	N	100KHz	20	1MHz	0.072	1.20
SMRH3D16-2R4N	2.4	N	100KHz	20	1MHz		
SMRH3D16-2R7N	2.7	N	100KHz	20	1MHz		
SMRH3D16-3R2N	3.2	N	100KHz	20	1MHz		
SMRH3D16-3R3N	3.3	N	100KHz	20	1MHz	0.085	1.10
SMRH3D16-4R7N	4.7	N	100KHz	30	1MHz	0.105	0.90
SMRH3D16-6R8N	6.8	N	100KHz	30	1MHz	0.170	0.73
SMRH3D16-8R2N	8.2	N	100KHz	30	1MHz		
SMRH3D16-100N	10	N	100KHz	30	1MHz	0.210	0.55
SMRH3D16-120 M	12	M	100KHz	35	1MHz		
SMRH3D16-150 M	15	M	100KHz	35	1MHz	0.295	0.45
SMRH3D16-180 M	18	M	100KHz	35	1MHz		
SMRH3D16-220 M	22	M	100KHz	35	1MHz	0.430	0.40
SMRH3D16-330 M	33	M	100KHz	35	1MHz	0.675	0.32
SMRH3D16-390 M	39	M	100KHz	35	1MHz		
SMRH3D16-470 M	47	M	100KHz	35	1MHz		

SMRH3D28 Series

MINIATURE SMD CHIP CHOKE COILS

Part No.	Inductance (uH)			Quality Factor		DCR (OHM) Max	Rated DC Current (Amp)Max
	Nominal Value	Tole.	Test Freq.	Spec. Min	Test Freq.		
SMRH3D28-1R5N	1.5	N	100KHz	20	1MHz		
SMRH3D28-2R2N	2.2	N	100KHz	20	1MHz		
SMRH3D28-2R4N	2.4	N	100KHz	20	1MHz		
SMRH3D28-2R7N	2.7	N	100KHz	20	1MHz		
SMRH3D28-3R2N	3.2	N	100KHz	20	1MHz		
SMRH3D28-3R3N	3.3	N	100KHz	20	1MHz	0.072	2.0
SMRH3D28-4R7N	4.7	N	100KHz	30	1MHz	0.088	1.65
SMRH3D28-6R8N	6.8	N	100KHz	30	1MHz	0.119	1.24
SMRH3D28-8R2N	8.2	N	100KHz	30	1MHz		
SMRH3D28-100N	10	N	100KHz	30	1MHz	0.145	1.05
SMRH3D28-120 M	12	M	100KHz	35	1MHz		
SMRH3D28-150 M	15	M	100KHz	35	1MHz	0.213	0.90
SMRH3D28-180 M	18	M	100KHz	35	1MHz		
SMRH3D28-220 M	22	M	100KHz	35	1MHz	0.335	0.76
SMRH3D28-330 M	33	M	100KHz	35	1MHz	0.481	0.58
SMRH3D28-390 M	39	M	100KHz	35	1MHz		
SMRH3D28-470 M	47	M	100KHz	35	1MHz	0.599	0.48

SMRH4D18 Series

Part No.	Inductance (uH)			Quality Factor		DCR (OHM) Max	Rated DC Current (Amp)Max
	Nominal Value	Tole.	Test Freq.	Spec. Min	Test Freq.		
SMRH4D18-1R0N	1.0	N	100KHz	20	1MHz	0.045	1.72
SMRH4D18-1R2N	1.2	N	100KHz	20	1MHz		
SMRH4D18-1R8N	1.8	N	100KHz	20	1MHz		
SMRH4D18-2R2N	2.2	N	100KHz	20	1MHz	0.075	1.32
SMRH4D18-2R6N	2.6	N	100KHz	20	1MHz		
SMRH4D18-2R7N	2.7	N	100KHz	20	1MHz	0.105	1.28
SMRH4D18-3R0N	3.0	N	100KHz	20	1MHz		
SMRH4D18-3R3N	3.3	N	100KHz	20	1MHz	0.110	1.04
SMRH4D18-3R9N	3.9	N	100KHz	20	1MHz	0.155	0.88
SMRH4D18-4R1N	4.1	N	100KHz	30	1MHz		
SMRH4D18-4R2N	4.2	N	100KHz	30	1MHz		
SMRH4D18-4R7N	4.7	N	100KHz	30	1MHz	0.162	0.84
SMRH4D18-5R0N	5.0	N	100KHz	30	1MHz		
SMRH4D18-5R3N	5.3	N	100KHz	30	1MHz		
SMRH4D18-5R4N	5.4	N	100KHz	30	1MHz		
SMRH4D18-5R6N	5.6	N	100KHz	30	1MHz	0.170	0.80
SMRH4D18-6R0N	6.0	N	100KHz	30	1MHz		
SMRH4D18-6R2N	6.2	N	100KHz	30	1MHz		
SMRH4D18-6R8N	6.8	N	100KHz	30	1MHz	0.200	0.76
Part No.	Inductance (uH)			Quality Factor		DCR	Rated DC

MINIATURE SMD CHIP CHOKE COILS

	Nominal Value	Tole.	Test Freq.	Spec. Min	Test Freq.	(OHM) Max	Current (Amp)Max
SMRH4D18-7R3N	7.3	N	100KHz	30	1MHz		
SMRH4D18-7R4N	7.4	N	100KHz	30	1MHz		
SMRH4D18-8R2N	8.2	N	100KHz	30	1MHz	0.245	0.68
SMRH4D18-8R6N	8.6	N	100KHz	30	1MHz		
SMRH4D18-8R7N	8.7	N	100KHz	30	1MHz		
SMRH4D18-8R9N	8.9	N	100KHz	30	1MHz	0.200	0.61
SMRH4D18-100N	10	N	100KHz	35	0.796MHz	0.210	0.56
SMRH4D18-120 M	12	M	100KHz	35	0.796MHz	0.240	0.50
SMRH4D18-150 M	15	M	100KHz	35	0.796MHz	0.338	0.48
SMRH4D18-180 M	18	M	100KHz	35	0.796MHz	0.397	0.41
SMRH4D18-220 M	22	M	100KHz	35	0.796MHz	0.441	0.35
SMRH4D18-270 M	27	M	100KHz	35	0.796MHz	0.694	0.32
SMRH4D18-330 M	33	M	100KHz	35	0.796MHz	0.709	0.30
SMRH4D18-390 M	39	M	100KHz	35	0.796MHz		
SMRH4D18-470 M	47	M	100KHz	35	0.796MHz		
SMRH4D18-560 M	56	M	100KHz	35	0.796MHz		
SMRH4D18-680 M	68	M	100KHz	35	0.796MHz		
SMRH4D18-820 M	82	M	100KHz	35	0.796MHz		
SMRH4D18-101 M	100	M	100KHz	40	0.796MHz		
SMRH4D18-121 M	120	M	100KHz	40	0.796MHz		
SMRH4D18-151 M	150	M	100KHz	40	0.796MHz		
SMRH4D18-181 M	180	M	100KHz	40	0.796MHz		

SMRH4D28 Series

Part No.	Inductance (uH)			Quality Factor		DCR (OHM) Max	Rated DC Current (Amp)Max
	Nominal Value	Tole.	Test Freq.	Spec. Min	Test Freq.		
SMRH4D28-1R0N	1.0	N	100KHz	20	1MHz		
SMRH4D28-1R2N	1.2	N	100KHz	20	1MHz	0.023	2.56
SMRH4D28-1R8N	1.8	N	100KHz	20	1MHz	0.027	2.20
SMRH4D28-2R2N	2.2	N	100KHz	20	1MHz	0.031	2.04
SMRH4D28-2R6N	2.6	N	100KHz	20	1MHz		
SMRH4D28-2R7N	2.7	N	100KHz	20	1MHz	0.043	1.60
SMRH4D28-3R0N	3.0	N	100KHz	20	1MHz		
SMRH4D28-3R3N	3.3	N	100KHz	20	1MHz	0.049	1.57
SMRH4D28-3R9N	3.9	N	100KHz	20	1MHz	0.064	1.44
SMRH4D28-4R1N	4.1	N	100KHz	30	1MHz		
SMRH4D28-4R2N	4.2	N	100KHz	30	1MHz		
SMRH4D28-4R7N	4.7	N	100KHz	30	1MHz	0.072	1.32
SMRH4D28-5R0N	5.0	N	100KHz	30	1MHz		
SMRH4D28-5R3N	5.3	N	100KHz	30	1MHz		
SMRH4D28-5R4N	5.4	N	100KHz	30	1MHz		
Part No.	Inductance (uH)			Quality Factor		DCR (OHM)	Rated DC Current
	Nominal	Tole.	Test	Spec.	Test		

MINIATURE SMD CHIP CHOKE COILS

	Value		Freq.	Min	Freq.	Max	(Amp)Max
SMRH4D28-5R6N	5.6	N	100KHz	30	1MHz	0.100	1.17
SMRH4D28-6R0N	6.0	N	100KHz	30	1MHz		
SMRH4D28-6R2N	6.2	N	100KHz	30	1MHz		
SMRH4D28-6R8N	6.8	N	100KHz	30	1MHz	0.108	1.12
SMRH4D28-7R3N	7.3	N	100KHz	30	1MHz		
SMRH4D28-7R4N	7.4	N	100KHz	30	1MHz		
SMRH4D28-8R2N	8.2	N	100KHz	30	1MHz	0.117	1.04
SMRH4D28-8R6N	8.6	N	100KHz	30	1MHz		
SMRH4D28-8R7N	8.7	N	100KHz	30	1MHz		
SMRH4D28-8R9N	8.9	N	100KHz	30	1MHz		
SMRH4D28-100N	10	N	100KHz	35	1MHz	0.128	1.00
SMRH4D28-120 M	12	M	100KHz	35	1MHz	0.131	0.84
SMRH4D28-150 M	15	M	100KHz	35	1MHz	0.149	0.76
SMRH4D28-180 M	18	M	100KHz	35	1MHz	0.166	0.72
SMRH4D28-220 M	22	M	100KHz	35	1MHz	0.235	0.70
SMRH4D28-270 M	27	M	100KHz	35	1MHz	0.261	0.58
SMRH4D28-330 M	33	M	100KHz	35	1MHz	0.378	0.56
SMRH4D28-390 M	39	M	100KHz	35	1MHz	0.383	0.50
SMRH4D28-470 M	47	M	100KHz	35	1MHz	0.587	0.48
SMRH4D28-560 M	56	M	100KHz	35	1MHz	0.624	0.41
SMRH4D28-680 M	68	M	100KHz	35	1MHz	0.699	0.35
SMRH4D28-820 M	82	M	100KHz	35	1MHz	0.914	0.32
SMRH4D28-101 M	100	M	100KHz	40	0.796MHz	1.102	0.29
SMRH4D28-121 M	120	M	100KHz	40	0.796MHz	1.127	0.27
SMRH4D28-151 M	150	M	100KHz	40	0.796MHz	1.135	0.24
SMRH4D28-181M	180	M	100KHz	40	0.796MHz	1.154	0.22

SMRH5D18 Series

Part No.	Inductance (uH)			Quality Factor		DCR (OHM) Max	Rated DC Current (Amp)Max
	Nominal Value	Tole.	Test Freq.	Spec. Min	Test Freq.		
SMRH5D18-1R0N	1.0	N	100KHz	20	1MHz		
SMRH5D18-1R2N	1.2	N	100KHz	20	1MHz		
SMRH5D18-1R8N	1.8	N	100KHz	20	1MHz		
SMRH5D18-2R2N	2.2	N	100KHz	20	1MHz		
SMRH5D18-2R6N	2.6	N	100KHz	20	1MHz		
SMRH5D18-2R7N	2.7	N	100KHz	20	1MHz		
SMRH5D18-3R0N	3.0	N	100KHz	20	1MHz		
SMRH5D18-3R3N	3.3	N	100KHz	20	1MHz		
SMRH5D18-3R9N	3.9	N	100KHz	20	1MHz		
SMRH5D18-4R1N	4.1	N	100KHz	30	1MHz	0.057	1.95
SMRH5D18-4R2N	4.2	N	100KHz	30	1MHz		
Part No.	Inductance (uH)			Quality Factor		DCR (OHM) Max	Rated DC Current (Amp)Max
	Nominal Value	Tole.	Test Freq.	Spec. Min	Test Freq.		

MINIATURE SMD CHIP CHOKE COILS

SMRH5D18-4R7N	4.7	N	100KHz	30	1MHz		
SMRH5D18-5R0N	5.0	N	100KHz	30	1MHz		
SMRH5D18-5R3N	5.3	N	100KHz	30	1MHz	0.076	1.60
SMRH5D18-5R4N	5.4	N	100KHz	30	1MHz		
SMRH5D18-5R6N	5.6	N	100KHz	30	1MHz		
SMRH5D18-6R0N	6.0	N	100KHz	30	1MHz	0.096	1.40
SMRH5D18-6R2N	6.2	N	100KHz	30	1MHz		
SMRH5D18-6R8N	6.8	N	100KHz	30	1MHz		
SMRH5D18-7R3N	7.3	N	100KHz	30	1MHz		
SMRH5D18-7R4N	7.4	N	100KHz	30	1MHz		
SMRH5D18-8R2N	8.2	N	100KHz	30	1MHz		
SMRH5D18-8R6N	8.6	N	100KHz	30	1MHz		
SMRH5D18-8R7N	8.7	N	100KHz	30	1MHz		
SMRH5D18-8R9N	8.9	N	100KHz	30	1MHz	0.116	1.25
SMRH5D18-100N	10	N	100KHz	35	1MHz	0.124	1.20
SMRH5D18-120 M	12	M	100KHz	35	1MHz	0.153	1.10
SMRH5D18-150 M	15	M	100KHz	35	1MHz	0.196	0.97
SMRH5D18-180 M	18	M	100KHz	35	1MHz	0.210	0.85
SMRH5D18-220 M	22	M	100KHz	35	1MHz	0.290	0.80
SMRH5D18-270 M	27	M	100KHz	35	1MHz	0.330	0.75
SMRH5D18-330 M	33	M	100KHz	35	1MHz	0.386	0.65
SMRH5D18-390 M	39	M	100KHz	35	1MHz	0.520	0.57
SMRH5D18-470 M	47	M	100KHz	35	1MHz	0.595	0.54
SMRH5D18-560 M	56	M	100KHz	35	1MHz	0.665	0.50
SMRH5D18-680 M	68	M	100KHz	35	1MHz	0.840	0.43
SMRH5D18-820 M	82	M	100KHz	35	1MHz	0.978	0.41
SMRH5D18-101 M	100	M	100KHz	40	0.796MHz	1.200	0.36
SMRH5D18-121 M	120	M	100KHz	40	0.796MHz		
SMRH5D18-151 M	150	M	100KHz	40	0.796MHz		
SMRH5D18-181 M	180	M	100KHz	40	0.796MHz		

SMRH5D28 Series

Part No.	Inductance (uH)			Quality Factor		DCR (OHM) Max	Rated DC Current (Amp)Max
	Nominal Value	Tole.	Test Freq.	Spec. Min	Test Freq.		
SMRH5D28-1R0N	1.0	N	100KHz	20	1MHz		
SMRH5D28-1R2N	1.2	N	100KHz	20	1MHz		
SMRH5D28-1R8N	1.8	N	100KHz	20	1MHz		
SMRH5D28-2R2N	2.2	N	100KHz	20	1MHz		
SMRH5D28-2R6N	2.6	N	100KHz	20	1MHz	0.018	2.60
SMRH5D28-2R7N	2.7	N	100KHz	20	1MHz		
Part No.	Inductance (uH)			Quality Factor		DCR (OHM) Max	Rated DC Current (Amp)Max
	Nominal Value	Tole.	Test Freq.	Spec. Min	Test Freq.		
SMRH5D28-3R0N	3.0	N	100KHz	20	1MHz	0.024	2.40

MINIATURE SMD CHIP CHOKE COILS

SMRH5D28-3R3N	3.3	N	100KHz	20	1MHz		
SMRH5D28-3R9N	3.9	N	100KHz	20	1MHz		
SMRH5D28-4R1N	4.1	N	100KHz	30	1MHz		
SMRH5D28-4R2N	4.2	N	100KHz	30	1MHz	0.031	2.20
SMRH5D28-4R7N	4.7	N	100KHz	30	1MHz		
SMRH5D28-5R0N	5.0	N	100KHz	30	1MHz		
SMRH5D28-5R3N	5.3	N	100KHz	30	1MHz	0.038	1.90
SMRH5D28-5R4N	5.4	N	100KHz	30	1MHz		
SMRH5D28-5R6N	5.6	N	100KHz	30	1MHz		
SMRH5D28-6R0N	6.0	N	100KHz	30	1MHz		
SMRH5D28-6R2N	6.2	N	100KHz	30	1MHz	0.045	1.80
SMRH5D28-6R8N	6.8	N	100KHz	30	1MHz		
SMRH5D28-7R3N	7.3	N	100KHz	30	1MHz		
SMRH5D28-7R4N	7.4	N	100KHz	30	1MHz		
SMRH5D28-8R2N	8.2	N	100KHz	30	1MHz	0.053	1.60
SMRH5D28-8R6N	8.6	N	100KHz	30	1MHz		
SMRH5D28-8R7N	8.7	N	100KHz	30	1MHz		
SMRH5D28-8R9N	8.9	N	100KHz	30	1MHz		
SMRH5D28-100N	10	N	100KHz	35	1MHz	0.065	1.30
SMRH5D28-120 M	12	M	100KHz	35	1MHz	0.076	1.20
SMRH5D28-150 M	15	M	100KHz	35	1MHz	0.403	1.10
SMRH5D28-180 M	18	M	100KHz	35	1MHz	0.110	1.00
SMRH5D28-220 M	22	M	100KHz	35	1MHz	0.122	0.90
SMRH5D28-270 M	27	M	100KHz	35	1MHz	0.175	0.85
SMRH5D28-330 M	33	M	100KHz	35	1MHz	0.189	0.75
SMRH5D28-390 M	39	M	100KHz	35	1MHz	0.212	0.70
SMRH5D28-470 M	47	M	100KHz	35	1MHz	0.260	0.62
SMRH5D28-560 M	56	M	100KHz	35	1MHz	0.305	0.58
SMRH5D28-680 M	68	M	100KHz	35	1MHz	0.355	0.52
SMRH5D28-820 M	82	M	100KHz	35	1MHz	0.463	
SMRH5D28-101 M	100	M	100KHz	40	0.796MHz	0.520	0.42
SMRH5D28-121 M	120	M	100KHz	40	0.796MHz		
SMRH5D28-151 M	150	M	100KHz	40	0.796MHz		
SMRH5D28-181 M	180	M	100KHz	40	0.796MHz		

SMRH6D28 Series

Part No.	Inductance (uH)			Quality Factor		DCR (OHM) Max	Rated DC Current (Amp)Max
	Nominal Value	Tole.	Test Freq.	Spec. Min	Test Freq.		

MINIATURE SMD CHIP CHOKE COILS

SMRH6D28-1R2N	1.2	N	100KHz	20	1MHz		
SMRH6D28-1R8N	1.8	N	100KHz	20	1MHz		
SMRH6D28-2R2N	2.2	N	100KHz	20	1MHz		
SMRH6D28-2R7N	2.7	N	100KHz	20	1MHz		
SMRH6D28-3R0N	3.0	N	100KHz	20	1MHz		
SMRH6D28-3R3N	3.3	N	100KHz	20	1MHz	0.024	3.00
SMRH6D28-3R9N	3.9	N	100KHz	20	1MHz		
SMRH6D28-4R1N	4.1	N	100KHz	30	1MHz	0.027	2.60
SMRH6D28-4R2N	4.2	N	100KHz	30	1MHz		
SMRH6D28-4R7N	4.7	N	100KHz	30	1MHz		
SMRH6D28-5R0N	5.0	N	100KHz	30	1MHz	0.031	2.40
SMRH6D28-5R3N	5.3	N	100KHz	30	1MHz		
SMRH6D28-5R4N	5.4	N	100KHz	30	1MHz		
SMRH6D28-5R6N	5.6	N	100KHz	30	1MHz		
SMRH6D28-6R0N	6.0	N	100KHz	30	1MHz	0.035	2.25
SMRH6D28-6R2N	6.2	N	100KHz	30	1MHz		
SMRH6D28-6R8N	6.8	N	100KHz	30	1MHz		
SMRH6D28-7R3N	7.3	N	100KHz	30	1MHz	0.054	2.10
SMRH6D28-7R4N	7.4	N	100KHz	30	1MHz		
SMRH6D28-8R2N	8.2	N	100KHz	30	1MHz		
SMRH6D28-8R6N	8.6	N	100KHz	30	1MHz	0.058	1.85
SMRH6D28-8R7N	8.7	N	100KHz	30	1MHz		
SMRH6D28-8R9N	8.9	N	100KHz	30	1MHz		
SMRH6D28-100N	10	N	100KHz	35	1MHz	0.065	1.70
SMRH6D28-120 M	12	M	100KHz	35	1MHz	0.07	1.55
SMRH6D28-150 M	15	M	100KHz	35	1MHz	0.084	1.40
SMRH6D28-180 M	18	M	100KHz	35	1MHz	0.095	1.32
SMRH6D28-220 M	22	M	100KHz	35	1MHz	0.128	1.20
SMRH6D28-270 M	27	M	100KHz	35	1MHz	0.142	1.05
SMRH6D28-330 M	33	M	100KHz	35	1MHz	0.165	0.97
SMRH6D28-390 M	39	M	100KHz	35	1MHz	0.210	0.86
SMRH6D28-470 M	47	M	100KHz	35	1MHz	0.238	0.80
SMRH6D28-560M	56	M	100KHz	35	1MHz	0.277	0.73
SMRH6D28-680 M	68	M	100KHz	35	1MHz	0.304	0.65
SMRH6D28-820 M	82	M	100KHz	35	1MHz	0.390	0.60
SMRH6D28-101 M	100	M	100KHz	40	0.796MHz	0.535	0.54
SMRH6D28-121 M	120	M	100KHz	40	0.796MHz		
SMRH6D28-151 M	150	M	100KHz	40	0.796MHz		
SMRH6D28-181 M	180	M	100KHz	40	0.796MHz		

MINIATURE SMD CHIP CHOKE COILS

SMRH6D38 Series

Part No.	Inductance (uH)			Quality Factor		DCR (OHM) Max	Rated DC Current (Amp)Max
	Nominal Value	Tole.	Test Freq.	Spec. Min	Test Freq.		
SMRH6D38-1R0N	1.0	N	100KHz	20	1MHz		
SMRH6D38-1R2N	1.2	N	100KHz	20	1MHz		
SMRH6D38-1R8N	1.8	N	100KHz	20	1MHz		
SMRH6D38-2R2N	2.2	N	100KHz	20	1MHz		
SMRH6D38-2R7N	2.7	N	100KHz	20	1MHz		
SMRH6D38-3R0N	3.0	N	100KHz	20	1MHz		
SMRH6D38-3R3N	3.3	N	100KHz	20	1MHz	0.020	3.50
SMRH6D38-3R9N	3.9	N	100KHz	20	1MHz		
SMRH6D38-4R1N	4.1	N	100KHz	30	1MHz		
SMRH6D38-4R2N	4.2	N	100KHz	30	1MHz		
SMRH6D38-4R7N	4.7	N	100KHz	30	1MHz		
SMRH6D38-5R0N	5.0	N	100KHz	30	1MHz	0.024	2.90
SMRH6D38-5R3N	5.3	N	100KHz	30	1MHz		
SMRH6D38-5R4N	5.4	N	100KHz	30	1MHz		
SMRH6D38-5R6N	5.6	N	100KHz	30	1MHz		
SMRH6D38-6R0N	6.0	N	100KHz	30	1MHz		
SMRH6D38-6R2N	6.2	N	100KHz	30	1MHz	0.027	2.50
SMRH6D38-6R8N	6.8	N	100KHz	30	1MHz		
SMRH6D38-7R3N	7.3	N	100KHz	30	1MHz		
SMRH6D38-7R4N	7.4	N	100KHz	30	1MHz	0.031	2.30
SMRH6D38-8R2N	8.2	N	100KHz	30	1MHz		
SMRH6D38-8R6N	8.6	N	100KHz	30	1MHz		
SMRH6D38-8R7N	8.7	N	100KHz	30	1MHz	0.034	2.20
SMRH6D38-8R9N	8.9	N	100KHz	30	1MHz		
SMRH6D38-100N	10	N	100KHz	35	1MHz	0.038	2.00
SMRH6D38-120 M	12	M	100KHz	35	1MHz	0.053	1.70
SMRH6D38-150 M	15	M	100KHz	35	1MHz	0.057	1.60
SMRH6D38-180 M	18	M	100KHz	35	1MHz	0.092	1.50
SMRH6D38-220 M	22	M	100KHz	35	1MHz	0.096	1.30
SMRH6D38-270 M	27	M	100KHz	35	1MHz	0.109	1.20
SMRH6D38-330 M	33	M	100KHz	35	1MHz	0.124	1.10
SMRH6D38-390 M	39	M	100KHz	35	1MHz	0.138	1.00
SMRH6D38-470 M	47	M	100KHz	35	1MHz	0.155	0.95
SMRH6D38-560 M	56	M	100KHz	35	1MHz	0.202	0.85
SMRH6D38-680 M	68	M	100KHz	35	1MHz	0.234	0.75
SMRH6D38-820 M	82	M	100KHz	35	1MHz	0.324	0.70
SMRH6D38-101 M	100	M	100KHz	40	0.796MHz	0.358	0.62
SMRH6D38-121 M	120	M	100KHz	40	0.796MHz		
SMRH6D38-151M	150	M	100KHz	40	0.796MHz		
SMRH6D38-181 M	180	M	100KHz	40	0.796MHz		